



Architect/Engineering Specifications:

Replacement parts for T&S glass filler. Certified to NSF 61–Section 9 and NSF 372.

Job Name	_____
Model Specified	_____ Quantity _____
Variations Specified	_____
Date	_____



015588-40 (1)
Adjustable Outlet
w/ Hex Key

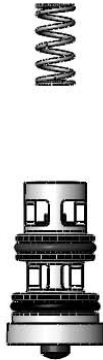

015589-40 (1)
Valve Assembly
w/ Valve Spring

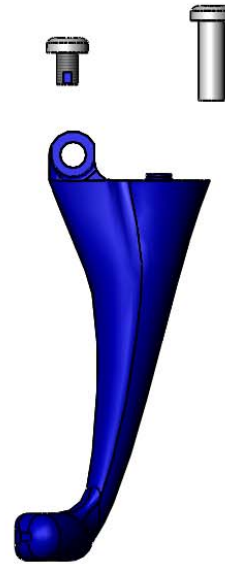

015550-45 (1)
Lever Arm Repair Kit
w/ Screw and Nut

Features & Benefits:

- Blue push back actuator arm repair kit w/ screw & nut
- Valve assembly w/ valve spring
- Adjustable outlet w/ hex key
- Material: thermoplastic arm and adjustable outlet

Product Compliance:

- NSF 61 - Section 9
- NSF 372 (Low Lead Content)



Warranty: One Year (Limited)

Performance Data:

- N/A

