



T&S BRASS AND BRONZE WORKS, INC.

2 Saddleback Cove / P.O. Box 1088

Travelers Rest, SC 29690

Model No.

016876-45K

Item No.

Travelers Rest, SC: 800-476-4103 • Simi Valley, CA: 800-423-0150 • Fax: 864-834-3518 • www.tsbrass.com

This Space for Architect/Engineer Approval

Job Name _____ Date _____

Model Specified _____ Quantity _____

Customer/Wholesaler _____

Contractor _____

Architect/Engineer _____

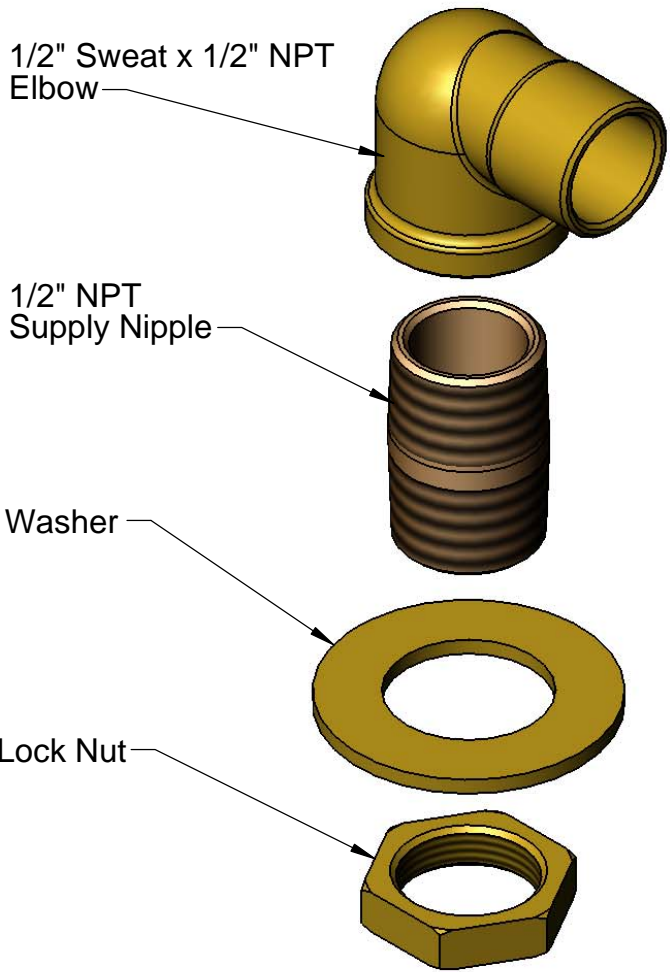

Product Specifications:
Power Soak Inlet Elbow Kit

Drawn

KJG

Checked

DMH

Approved

JHB

Scale:

1:1

Date:

12/05/11



T&S BRASS AND BRONZE WORKS, INC.

2 Saddleback Cove / P.O. Box 1088

Travelers Rest, SC 29690

Model No.

016876-45K

Item No.

Travelers Rest, SC: 800-476-4103 • Simi Valley, CA: 800-423-0150 • Fax: 864-834-3518 • www.tsbrass.com

ITEM	PART NO.	DESCRIPTION
1	016876-45	1/2" Sweat x 1/2" NPT Elbow
2	016878-20	1/2" NPT x 1 1/4" Supply Nipple
3	000999-45	Brass Lock Washer
4	002954-45	Shank Lock Nut

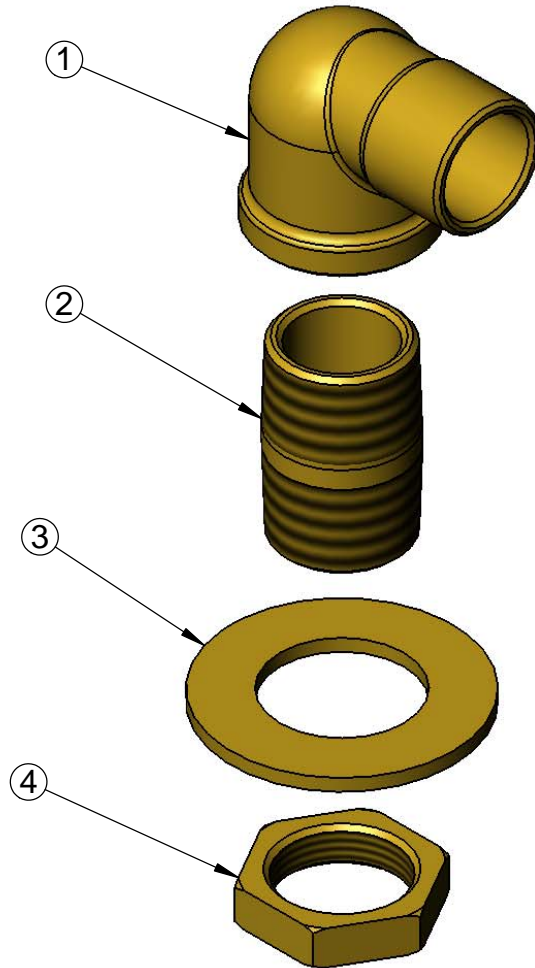

Product Specifications:
Power Soak Inlet Elbow Kit

Drawn

KJG

Checked

DMH

Approved

JHB

Scale:

NTS

Date:

12/05/11