



**T&S BRASS AND BRONZE WORKS, INC.**  
 2 Saddleback Cove / P.O. Box 1088  
 Travelers Rest, SC 29690

Model No.  
**001121-45**

Item No.

Travelers Rest, SC: 800-476-4103 • Simi Valley, CA: 800-423-0150 • Fax: 864-834-3518 • www.tsbrass.com

This Space for Architect/Engineer Approval

Job Name \_\_\_\_\_ Date \_\_\_\_\_

Model Specified \_\_\_\_\_ Quantity \_\_\_\_\_

Customer/Wholesaler \_\_\_\_\_

Contractor \_\_\_\_\_

Architect/Engineer \_\_\_\_\_

Ø2 1/8"  
 [55mm]



1/2"  
 [12mm]

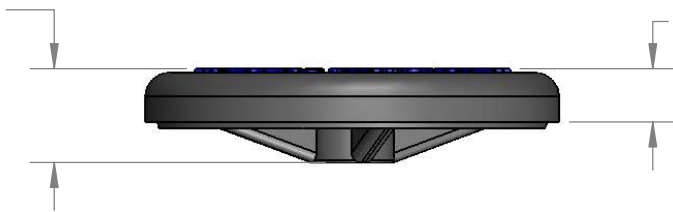

1/4"  
 [7mm]

Product Specifications:  
 B-0107 Grey Spray Face, 1.42 GPM Flow Rate

Product Compliance:  
 NSF 61 - Section 9  
 NSF 372 (Low Lead Content)  
 EPAAct 2005 (PRSV)