



**T&S BRASS AND BRONZE WORKS, INC.**  
 2 Saddleback Cove / P.O. Box 1088  
 Travelers Rest, SC 29690

Model No.  
**HW-4C-48VB**

Item No.

Travelers Rest, SC: 800-476-4103 • Simi Valley, CA: 800-423-0150 • Fax: 864-834-3518 • www.tsbrass.com

This Space for Architect/Engineer Approval

Job Name \_\_\_\_\_ Date \_\_\_\_\_

Model Specified \_\_\_\_\_ Quantity \_\_\_\_\_

Customer/Wholesaler \_\_\_\_\_

Contractor \_\_\_\_\_

Architect/Engineer \_\_\_\_\_

# SAFE·T·LINK

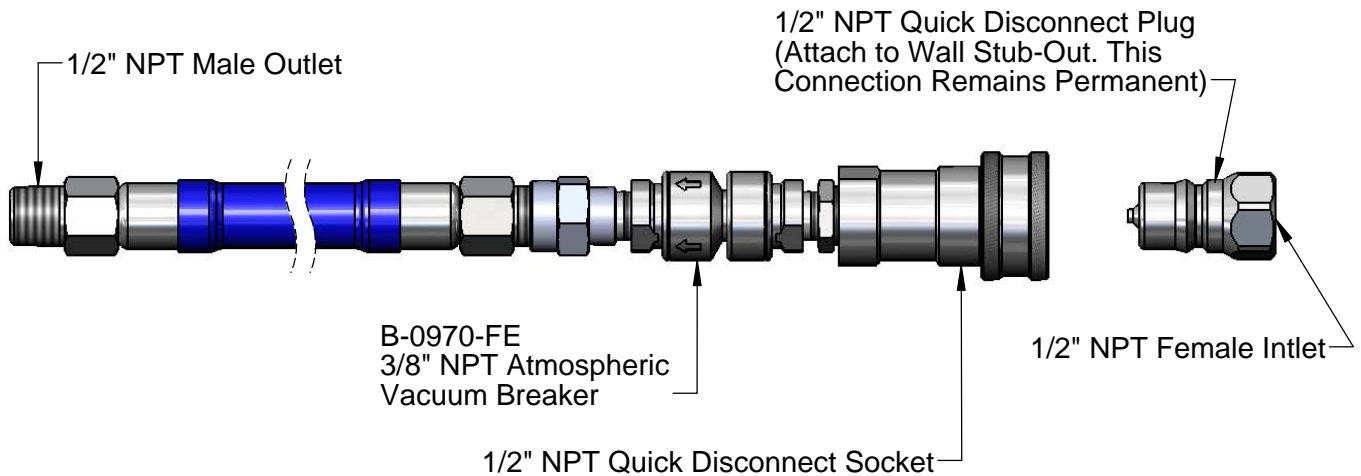

Product Specifications:  
 1/2" NPT x 48" Water Hose w/ Quick Disconnect & Vacuum Breaker

Drawn  
**DHL**

Checked  
**KJG**

Approved  
**JHB**

Scale:  
**3:8**

Date:  
**07/17/13**



**T&S BRASS AND BRONZE WORKS, INC.**  
 2 Saddleback Cove / P.O. Box 1088  
 Travelers Rest, SC 29690

Model No.  
**HW-4C-48VB**

Item No.

Travelers Rest, SC: 800-476-4103 • Simi Valley, CA: 800-423-0150 • Fax: 864-834-3518 • www.tsbrass.com

ITEM NO.	SALES NO.	DESCRIPTION
1	001995-25	1/2" NPT x 3/8" NPT Adapter
2	002535-25	3/8" Close Nipple
3	B-0970-FE	3/8" NPT Vacuum Breaker
4	001359-40	Hex Bushing, 1/2" Male x 3/8" Female
5	AW-5C	Water Appliance Connector 1/2" NPT Stainless Steel Quick Disconnect Socket/Plug
6	HW-2C-48	1/2" NPT x 48" Water Hose

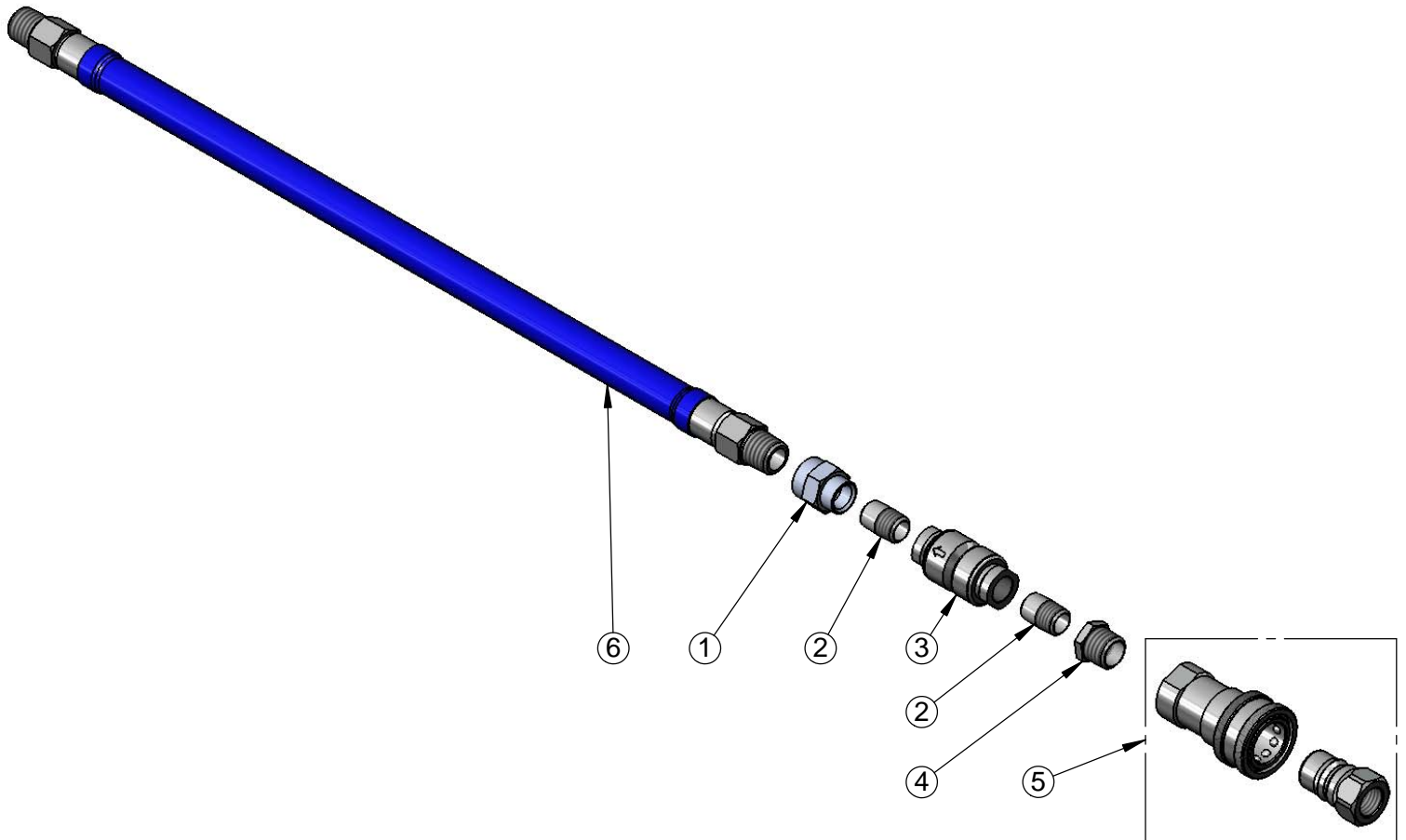

Product Specifications:  
 1/2" NPT x 48" Water Hose w/ Quick Disconnect & Vacuum Breaker

Drawn <b>DHL</b>	Checked <b>KJG</b>	Approved <b>JHB</b>
Scale: <b>NTS</b>		Date: <b>07/17/13</b>