



T&S BRASS AND BRONZE WORKS, INC.
 2 Saddleback Cove / P.O. Box 1088
 Travelers Rest, SC 29690

Model No.
PG-1WREV

Item No.

Travelers Rest, SC: 800-476-4103 • Simi Valley, CA: 800-423-0150 • Fax: 864-834-3518 • www.tsbrass.com

This Space for Architect/Engineer Approval

Job Name _____ Date _____

Model Specified _____ Quantity _____

Customer/Wholesaler _____

Contractor _____

Architect/Engineer _____

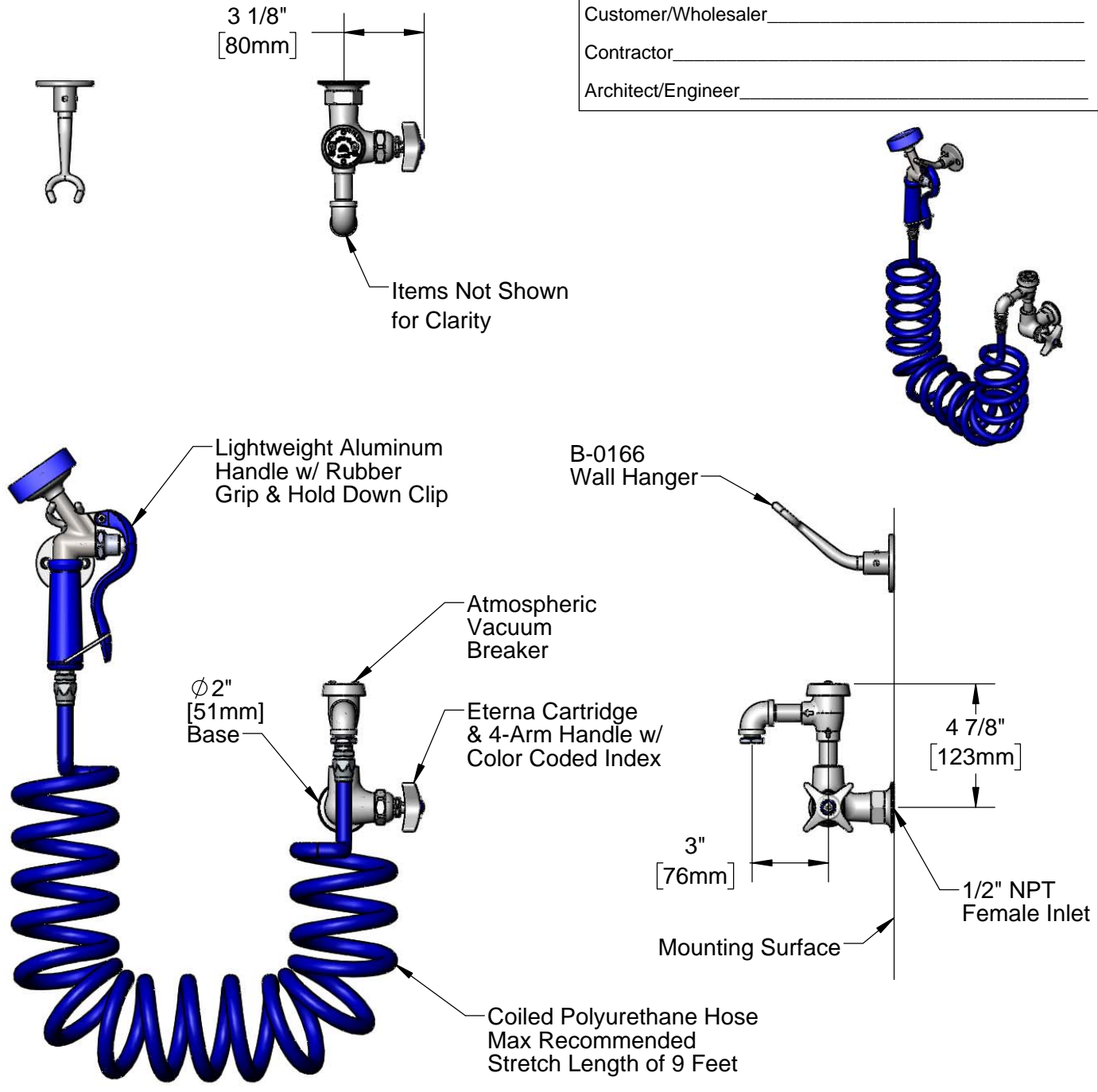

Product Specifications:
 Pet Grooming Unit:
 Single Hole Wall Mount Faucet, Eterna Cartridge, 4-Arm Handle, Vacuum Breaker, 9 Ft Coiled Hose & Angled Aluminum Spray Valve

Product Compliance:
 ASME A112.18.1 / CSA B125.1
 NSF 61 Exempt (Non-Potable)
 CSA B64.8 (VB)



T&S BRASS AND BRONZE WORKS, INC.
 2 Saddleback Cove / P.O. Box 1088
 Travelers Rest, SC 29690

Model No.
PG-1WREV

Item No.

Travelers Rest, SC: 800-476-4103 • Simi Valley, CA: 800-423-0150 • Fax: 864-834-3518 • www.tsbrass.com

ITEM NO.	SALES NO.	DESCRIPTION
1	B-0166	Wall Hook
2	PG-35AV	Aluminum 35° Spray Valve
3	B-0968	3/8" NPT Vacuum Breaker
4	PG-35AV-CH	Spray Valve w/ 9' of Coiled Hose
5	000922-45	Lever Handle Screw
6	001660-45	Blue Index-CW
7	002521-45	4-Arm Handle
8	005960-40	Eterna Cartridge, RTC

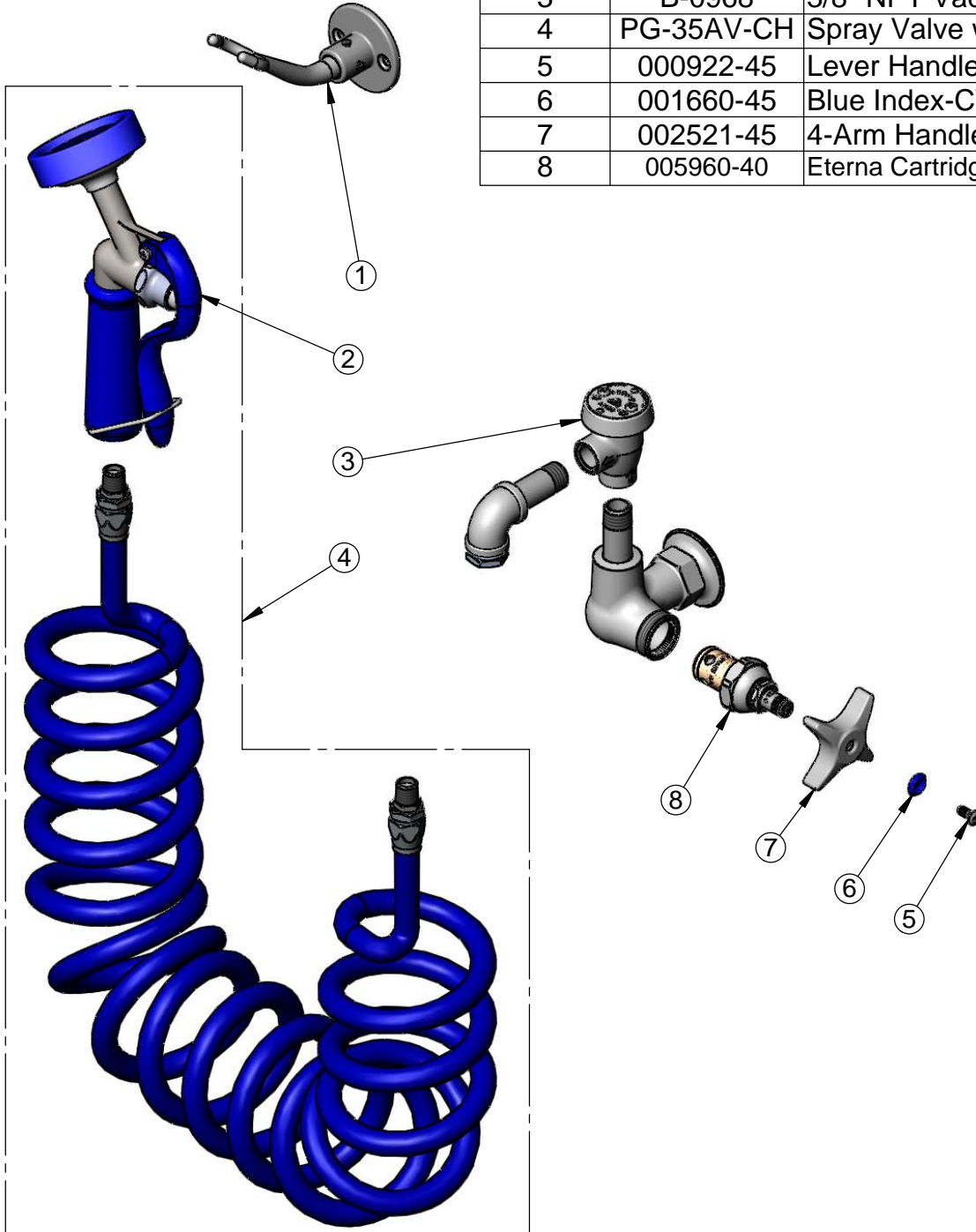

Product Specifications:
 Pet Grooming Unit:
 Single Hole Wall Mount Faucet, Eterna Cartridge, 4-Arm Handle, Vacuum Breaker, 9 Ft Coiled Hose & Angled Aluminum Spray Valve

Product Compliance:
 ASME A112.18.1 / CSA B125.1
 NSF 61 Exempt (Non-Potable)
 CSA B64.8 (VB)