



# T&S BRASS AND BRONZE WORKS, INC.

2 Saddleback Cove / P.O. Box 1088  
Travelers Rest, SC 29690

Model No.

**B-2990-FLWH4**

Item No.

Travelers Rest, SC: 800-476-4103 • Simi Valley, CA: 800-423-0150 • Fax: 864-834-3518 • www.tsbrass.com



**ADA Compliant**

This Space for Architect/Engineer Approval

Job Name \_\_\_\_\_ Date \_\_\_\_\_

Model Specified \_\_\_\_\_ Quantity \_\_\_\_\_

Customer/Wholesaler \_\_\_\_\_

Contractor \_\_\_\_\_

Architect/Engineer \_\_\_\_\_

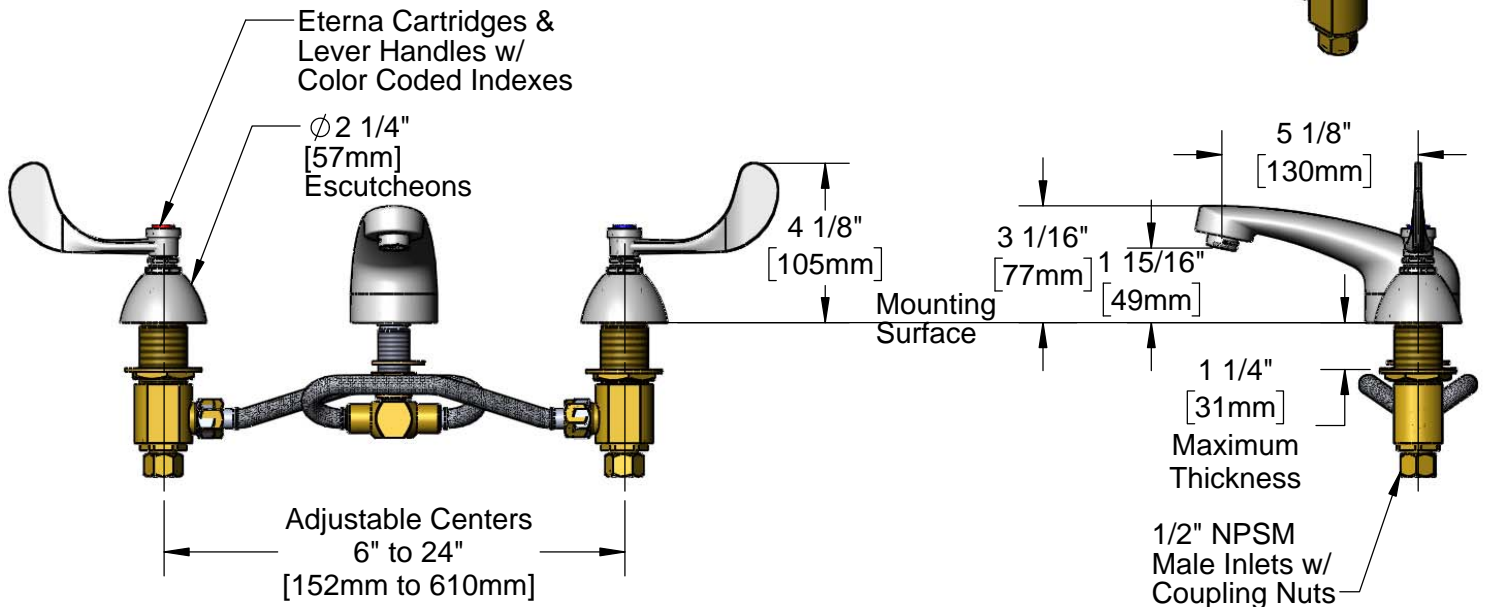
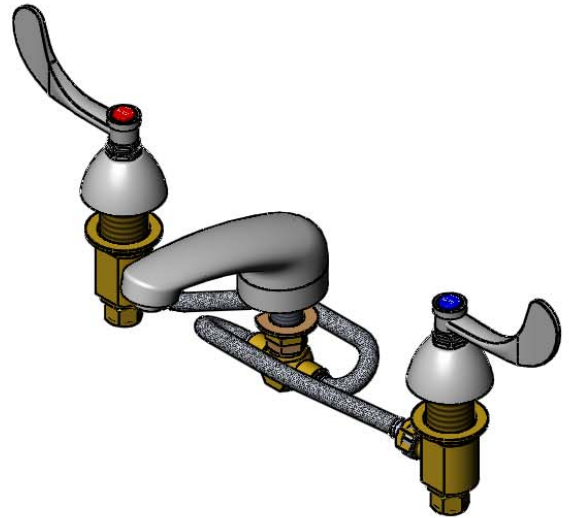
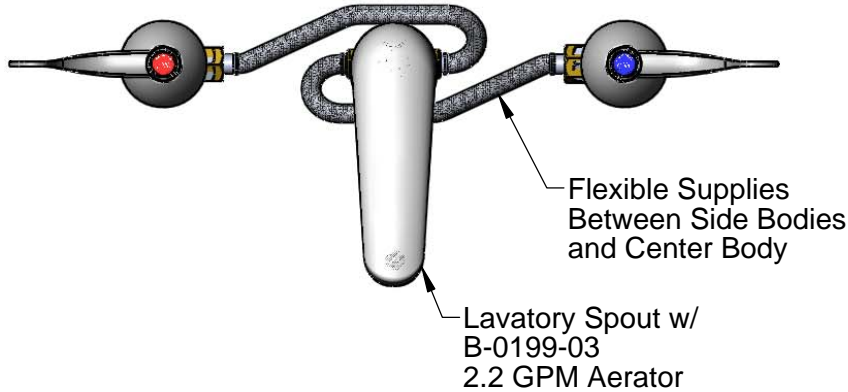

**Rough-In Requirement:**  
Center Shank:  $\varnothing 1''$  [25mm] Mounting Hole  
Hot/Cold Side:  $\varnothing 1 \frac{1}{2}''$  [38mm] Mounting Holes

**Product Specifications:**  
Adjustable Deck Mount Lavatory Faucet, Eterna Cartridges, Lever Handles, Lavatory Spout, 2.2 GPM Aerator & 1/2" NPSM Male Inlets

**Product Compliance:**  
ASME A112.18.1 / CSA B125.1  
NSF 61 - Section 9  
NSF 372 (Low Lead Content)  
ANSI A117.1 (ADA)



**T&S BRASS AND BRONZE WORKS, INC.**  
 2 Saddleback Cove / P.O. Box 1088  
 Travelers Rest, SC 29690

Model No.  
**B-2990-FLWH4**

Item No.

Travelers Rest, SC: 800-476-4103 • Simi Valley, CA: 800-423-0150 • Fax: 864-834-3518 • www.tsbrass.com

ITEM NO.	SALES NO.	DESCRIPTION
1	B-0199-03	2.2 GPM Aerator
2	002954-45	Shank Lock Nut
3	001686-45	Blue Index - CW
4	000925-45	Lab Handle Screw
5	B-WH4	4" Wrist Action Handle
6	006477-40	Eterna Cartridge, LTC (Teflon) w/ Escutcheon Bonnet
7	000960-20	Lock Nut
8	002290-45	Lock Washer
9	011649-45	12" Flexible Supply Hose
10	000958-20	Coupling Nut
11	006478-40	Eterna Cartridge, RTC (Teflon) w/ Escutcheon Bonnet
12	001257-40	Bell Escutcheon
13	001194-45	Red Index - HW
47	001091-45	Beveled Rubber Washer (Ferrule)

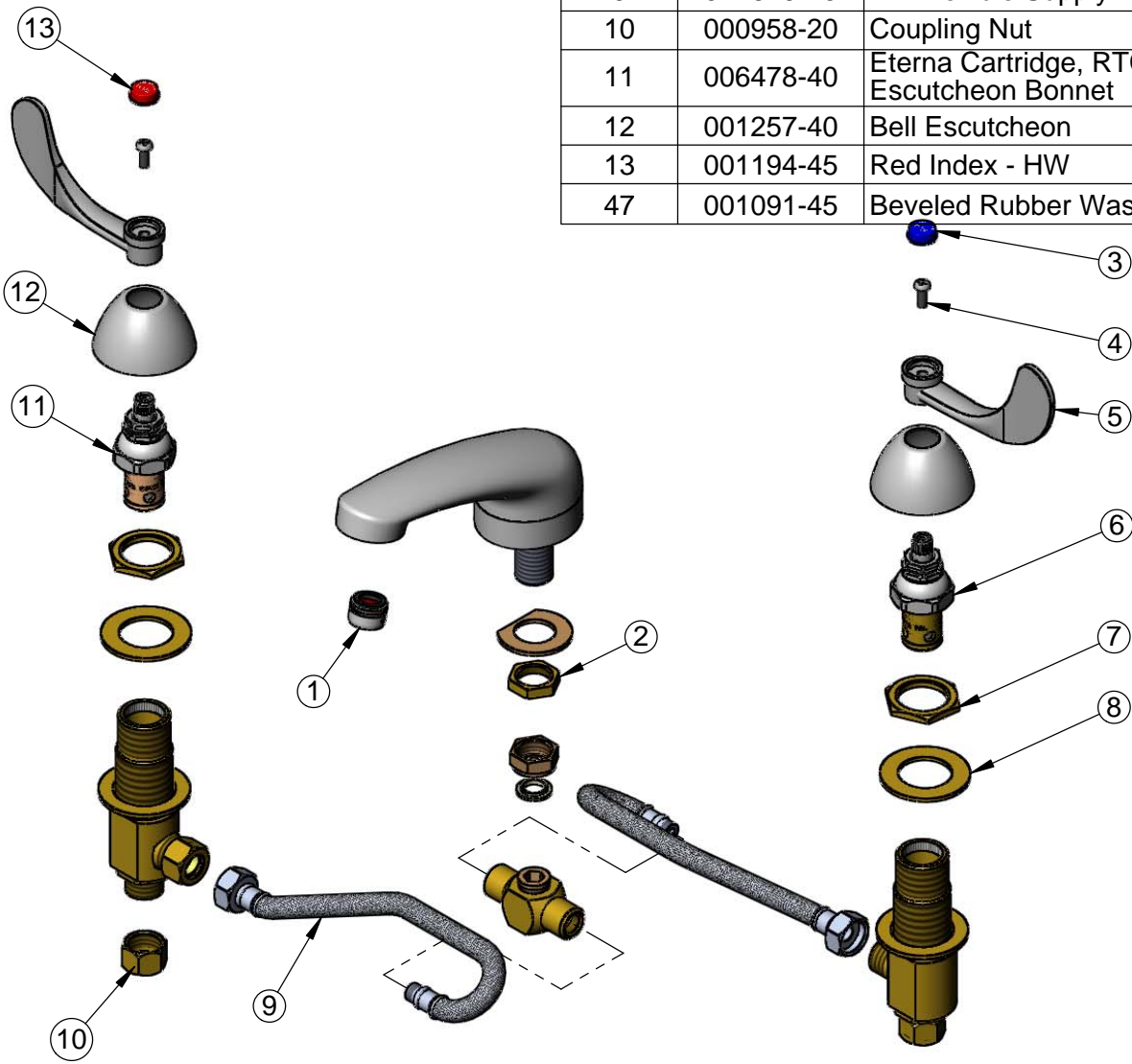

**Product Specifications:**  
 Adjustable Deck Mount Lavatory Faucet, Eterna Cartridges, Lever Handles, Lavatory Spout, 2.2 GPM Aerator & 1/2" NPSM Male Inlets

**Product Compliance:**  
 ASME A112.18.1 / CSA B125.1  
 NSF 61 - Section 9  
 NSF 372 (Low Lead Content)  
 ANSI A117.1 (ADA)