



T&S BRASS AND BRONZE WORKS, INC.

2 Saddleback Cove / P.O. Box 1088
Travelers Rest, SC 29690

Model No.

B-0442

Item No.

Travelers Rest, SC: 800-476-4103 • Simi Valley, CA: 800-423-0150 • Fax: 864-834-3518 • www.tsbrass.com

This Space for Architect/Engineer Approval

Job Name _____ Date _____

Model Specified _____ Quantity _____

Customer/Wholesaler _____

Contractor _____

Architect/Engineer _____

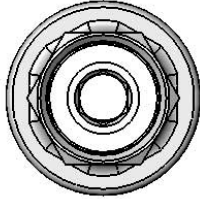

Faucet Flange Coupling
Nut Fits Standard T&S
Faucet Bodies.

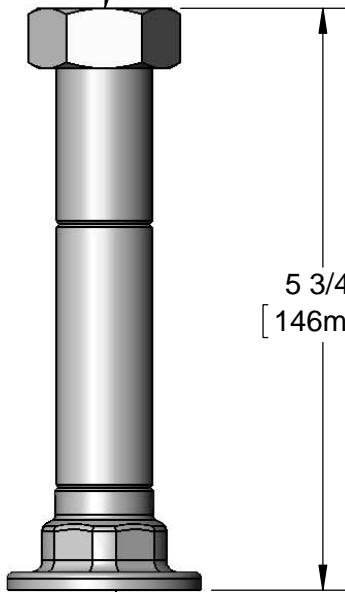

5 3/4"
[146mm]

Ø2"
[51mm]
Flanges w/
1/2" NPT
Female Inlets

Washer
(Included)

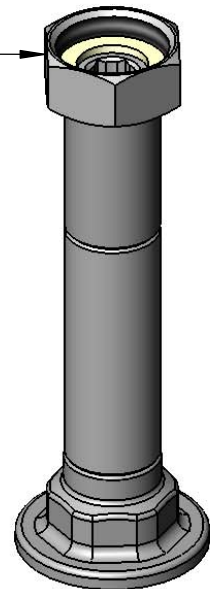

Note:

Adds 4 1/2" [114mm] Length to Standard 00AA Inlet

Product Specifications:

5 3/4" Faucet Inlet Extension, 1/2" NPT Female Inlet

Product Compliance:

ASME A112.18.1 / CSA B125.1
NSF 61 - Section 9
NSF 372 (Low Lead Content)